



MEASURING YOUR KITCHEN AND BATH

Accurate measurements of your kitchen or bath are important in designing your new cabinets. Please follow the steps listed in this kitchen and bath planner, and email the information to Info@bestmoderncabinets.com

Floor Plan

You will need to carefully configure the exact dimensions of your room. Your completed floor plan should resemble the diagram below. Be sure to show exact locations of doors, windows, hood vents, exhaust, gas lines, water lines, drain lines, outlets, switches, light fixtures, and heat vents.

NOTE: ALWAYS DOUBLE CHECK MEASUREMENTS

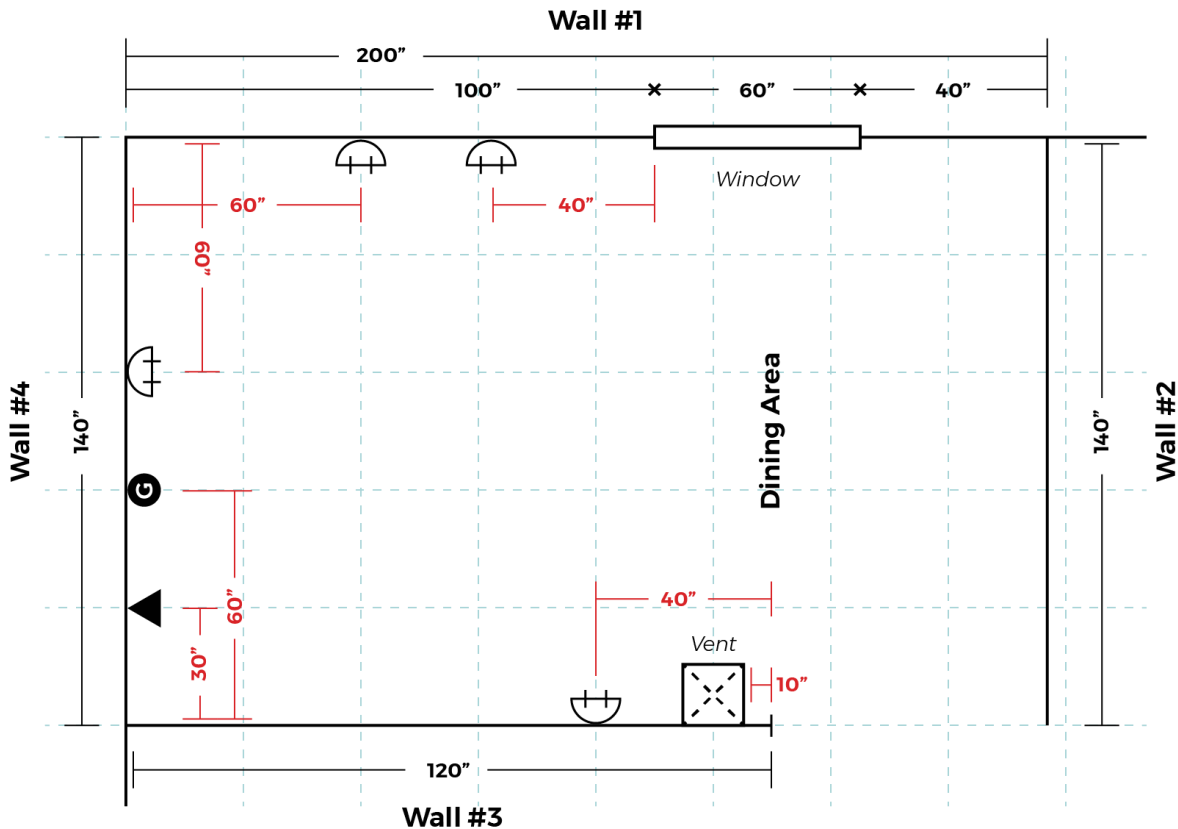



HOW TO MEASURE

Using a tape measure and graph paper, measure your room using the following steps:

Horizontal Measurement

1. Measure from wall to wall at 36" height.
2. Measure from corner to window or door opening.
3. Measure across opening from trim edge to trim edge.
4. Measure from edge of trim to far wall. Compare sum of #2, #3, and #4.
5. Mark exact location of water, drain, gas lines, electrical outlets, and switches on drawing.
6. Measure from wall to wall above window and compare to #1.

Vertical Measurement

7. Measure from floor to window sill.
8. Measure from window sill to top of window.
9. Measure from top of window to ceiling.
10. Measure from floor to ceiling—compare to sum of #7, #8, and #9.



Each large square represents 1 square ft. Each small square represents 3".

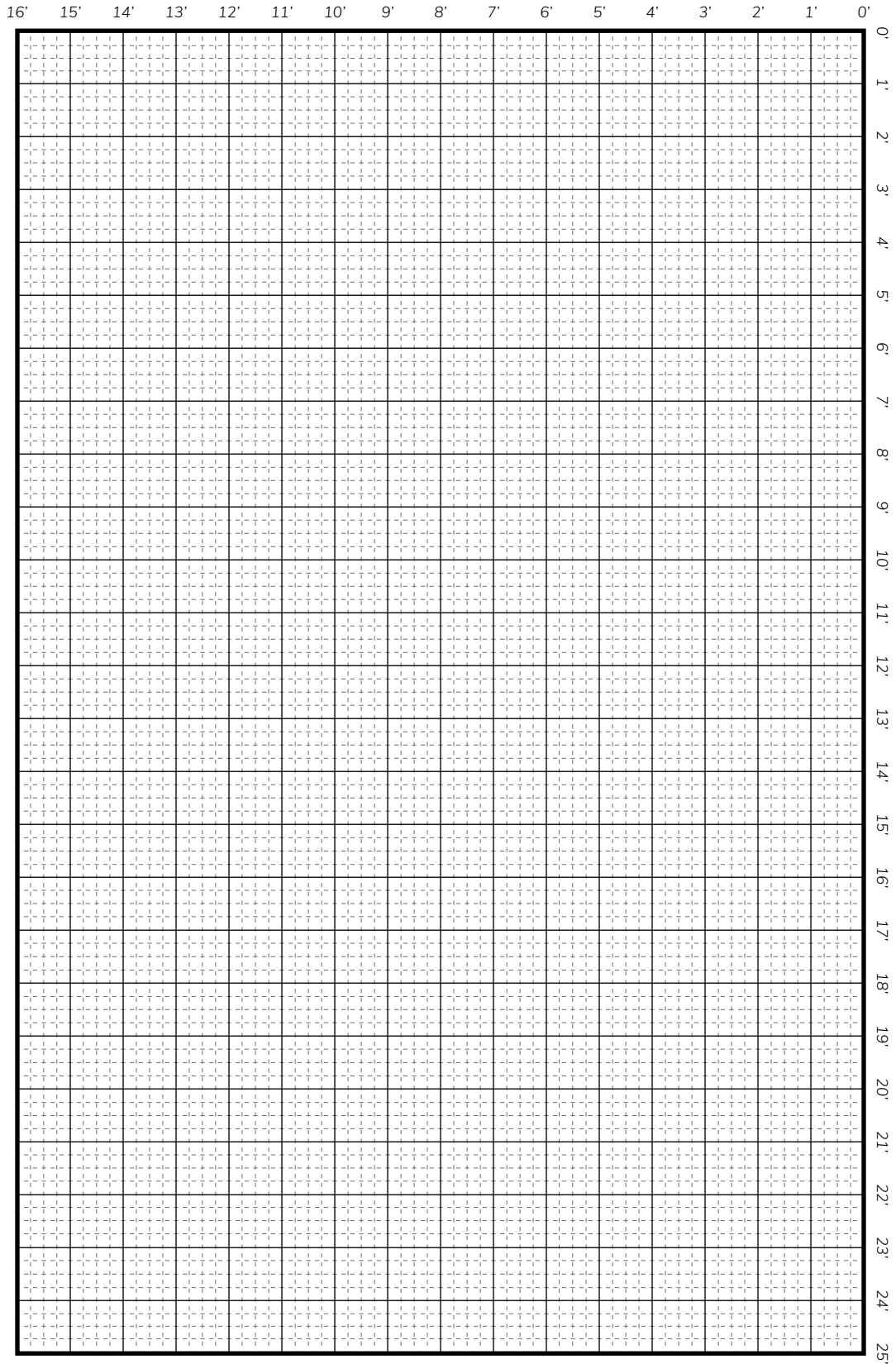



APPLIANCE AND FIXTURE INFORMATION



	Type	Size W x D x H	Hinge Position L/R <small>(Facing Appliance)</small>
	Refrigerator		
	Range		
	Cooktop		
	Exhaust Hood		
	Wall Oven		
	Microwave		
	Dishwasher		
	Sink		
	Disposal		
	Compactor		
	Freezer		
	Other		

